



NF E 11-099.
Type 1
for models
6 to 10 mm or type 2 for
all other models

Measuring inserts
for application
range
6 to 10 mm: steel,
hardened to HV30 550.
10 to 300 mm:
tungsten carbide tipped to
HRC \geq 70.

Wooden case

Identification
number

Declaration
of conformity

Calibration
certificate
upon request

ROCH ALESOMETER with Analogue Indication, Metric

Bore gauges with 3-line contact. All ROCH ALESOMETER let you measure not only through bores, but also blind bores as well as centring shoulders, except for the models covering the application range 6 to 10 mm.

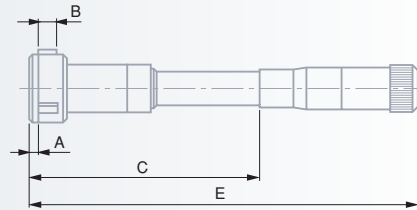
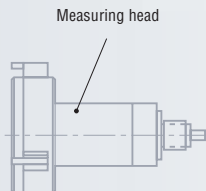
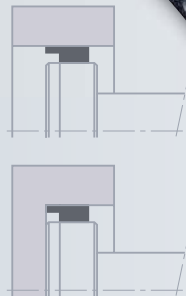

Single Bore Gauges, Complete

No	mm	mm	μ m	mm			
				A mm*	B mm	C mm	E mm
0081725001	6 ÷ 8	0,001	4	1,2	3	54,5	107
0081725003	8 ÷ 10	0,001	4	1,2	3	54,5	107
0081725006	10 ÷ 12,5	0,001	4	0,3	6,5	64,5	117
0081725008	12,5 ÷ 15	0,001	4	0,3	6,5	64,5	117
0081725010	15 ÷ 17,5	0,001	4	0,3	6,8	64,5	117
0081725012	17,5 ÷ 20	0,001	4	0,3	6,8	64,5	117
0081725014	20 ÷ 25	0,001	4	0,3	8,5	70	122,5
0081725016	25 ÷ 30	0,001	4	0,3	8,5	70	122,5
0081725018	30 ÷ 35	0,001	4	0,3	8,5	70	122,5
0081725020	35 ÷ 40	0,001	4	0,3	8,5	70	122,5
0081725022	40 ÷ 50	0,001	4	0,3	14,5	108,7	188,7
0081725024	50 ÷ 60	0,001	5	0,3	14,5	108,7	188,7
0081725026	60 ÷ 70	0,001	5	0,3	14,5	108,7	188,7
0081725028	70 ÷ 85	0,001	5	0,3	14,5	126,7	206,7
0081725030	85 ÷ 100	0,001	5	0,3	14,5	126,7	206,7
0081725032	100 ÷ 125	0,01	7	0,3	30	153,7	233,5
0081725034	125 ÷ 150	0,01	7	0,3	30	153,7	233,5
0081725036	150 ÷ 175	0,01	8	0,3	30	153,7	233,5
0081725038	175 ÷ 200	0,01	8	0,3	30	153,7	233,5
0081725040	200 ÷ 225	0,01	9	0,3	30	153,7	233,5
0081725042	225 ÷ 250	0,01	9	0,3	30	153,7	233,5
0081725044	250 ÷ 275	0,01	9	0,3	30	153,7	233,5
0081725046	275 ÷ 300	0,01	9	0,3	30	153,7	233,5

* Not applicable for models from 10 mm since the measuring inserts are close to the micrometer front face.

ROCH ALESOMETER with Analogue Indication – Full Metric Sets



NF E 11-099.
Type 1
for models
6 to 10 mm or type 2 for
all other models



Measuring inserts
for application
range
6 to 10 mm: steel,
hardened to HV30 550.
10 to 300 mm:
tungsten carbide tipped to
HRC ≥ 70.



For any additional
data, see on
previous page



Wooden case



Identification
number



Declaration
of conformity



Calibration
certificate
upon request

No	mm	No	mm	No	mm	No	mm
Full sets including		Single bore gauges		Setting rings	Extensions		
0081725063	6 ÷ 10	0081725001	6 ÷ 8	0211625101	8	0081625081	100
		0081725003	8 ÷ 10				
0081725066	10 ÷ 20	0081725006	10 ÷ 12,5	0211625102	12,5	0081625082	100
		0081725008	12,5 ÷ 15	0211625103	17,5		
		0081725010	15 ÷ 17,5				
		0081725012	17,5 ÷ 20				
0081725068	20 ÷ 40	0081725014	20 ÷ 25	0211625104	25	0081625083	150
		0081725016	25 ÷ 30	0211625105	35		
		0081725018	30 ÷ 35				
		0081725020	35 ÷ 40				
0081725070	40 ÷ 100	0081725022	40 ÷ 50	0211625106	45	0081625084	150
		0081725024	50 ÷ 60	0211625107	60		
		0081725026	60 ÷ 70	0211625109	85		
		0081725028	70 ÷ 85				
		0081725030	85 ÷ 100				
0081725072	100 ÷ 150	0081725032	100 ÷ 125	0211625111	125	0081625085	200
		0081725034	125 ÷ 150				

Extensions



Hardened steel.
Insulated body
against hand
warmth



Identification
number



Declaration
of conformity

Setting rings



NF E 11-011,
type A2



Steel, hardened
to 60 HRC



Bore related
tolerance
± (3 μm + 10 · 10⁻⁵ D) μm



D = Nominal
diameter in mm
(1 μm + 5 · 10⁻⁵ D) μm



Shipping box



Identification
number



Calibration
certificate
upon request

Extensions for Depth Increase

No	mm	mm
0081625081	6 ÷ 10	100
0081625082	10 ÷ 20	100
0081625083	20 ÷ 40	150
0081625084	40 ÷ 100	150
0081625085	100 ÷ 300	200

ROCH Setting Rings

No	mm	No	mm
0211625101	8	0211625110	90
0211625102	12,5	0211625111	125
0211625103	17,5	0211625112	150
0211625104	25	0211625113	175
0211625105	35	0211625114	200
0211625106	45	0211625115	225
0211625107	60	0211625116	250
0211625108	75	0211625117	275
0211625109	85		