

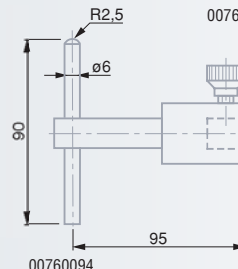

## Optional Accessories for TESA MICRO-HITE plus M 350 / 600 / 900 TESA MICRO-HITE 350 / 600 / 900 TESA-HITE 400 / 700 TESA-HITE magna 400 / 700

No.	Description	Availability	Packaging
00760173	Partial accessory set	●	
00760148	Full accessory set	●	●
<i>Supplied in a suited plastic case with the following items:</i>			
00760061	1 Measuring insert with a 3 mm dia. carbide ball tip	●	●
00760060	1 Measuring insert with a 3 mm dia. carbide ball tip	●	●
Measuring inserts with carbide, barrel-shaped measuring faces for cylindrical bores as well as for determining the position of metric inside threads (or similar).			
00760066	1 item with a 2,2 mm diameter (for threads M3 to M16)	●	●
00760067	1 item with a 4,5 mm diameter (for threads M6 to M48)	●	●
00760068	1 item with a 9,7 mm diameter for threads M12 to M150)	●	●
Measuring inserts with carbide disc tip for grooves, slots, centring shoulders etc.			
00760074	1 item, E = 1 mm / 4,5 mm diameter	●	●
00760075	1 item, E = 2 mm / 14 mm diameter	●	●
00760076	1 item, E = 3 mm / 19 mm diameter	●	●
00760082	1 2 mm dia. insert with a small cylindrical carbide meas. face	●	●
00760096	1 Holder for TESATAST measuring inserts with a M1,4 thread or any other one with a M2,5 thread.	●	●
TESATAST measuring inserts, carbide ball tip, M1,4 thread			
01860201	1 item with a 1 mm diameter	●	●
01860202	1 item with a 2 mm diameter	●	●
01860203	1 item with a 3 mm diameter	●	●
01860307	1 Wrench	●	●
00760093	1 Measuring insert with cylindrical measuring face (10 mm dia., 12 mm long). Stainless steel body, hardened. Tungsten carbide measuring face.	●	●
Insert holder for depth increase			
00760086	1 item for depth up to 110 mm (L = 75 mm)	●	●
00760087	1 item for depth up to 185 mm (L = 150 mm)	●	●
00760057	1 Insert holder for extending application range	●	●
00760094	1 Measuring insert with a stainless steel pin, hardened. Also with one flat and one spherical carbide measuring face. Interchangeable pin.	●	●
S07001622	Special insert holder for extending application range		

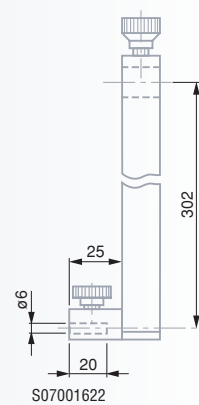
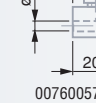
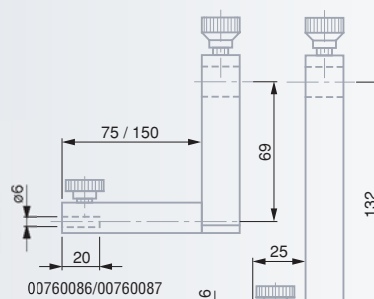
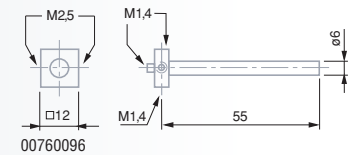
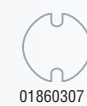
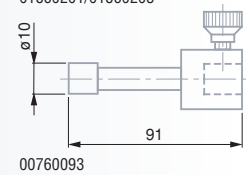
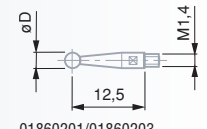
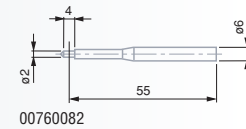
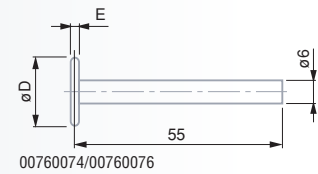
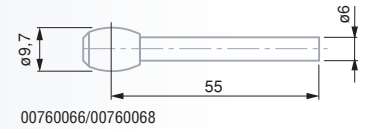
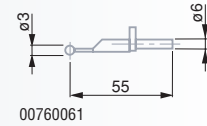
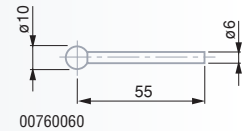

## Optional accessories for use with insert holder No. 00760223

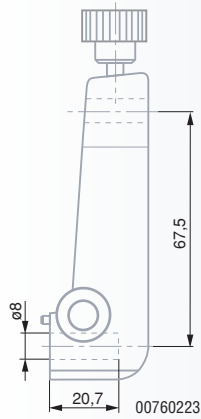

**Nº**



**00760223**

Holder for use with any measuring insert listed below

**0071684825**

Measuring insert with a 6 mm dia. tungsten carbide ball tip

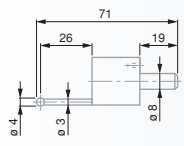
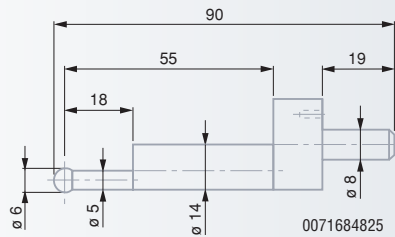

0071684815

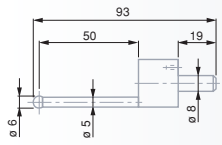

0071684816

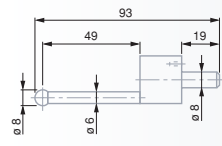

0071684832

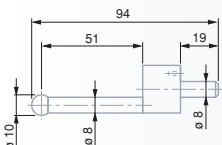

0071684829

**Nº**



**0071684849**

Accessory set

Consisting of:

- 0071684848** 1 Platen with protective plexiglass
- 0071684815** 1 Measuring insert with a 4 mm dia. tungsten carbide ball tip
- 0071684816** 1 Measuring insert with a 6 mm dia. tungsten carbide ball tip
- 0071684832** 1 Measuring insert with a 8 mm dia. tungsten carbide ball tip
- 0071684829** 1 Measuring insert with a 10 mm dia. tungsten carbide ball tip
- 0071684817** 1 Long measuring insert with a 10 mm dia. tungsten carbide ball tip
- 0071684826** 1 Attachment for interchangeable inserts with M1,4 thread. Supplied with 1 insert No. 01860201 having a 1 mm dia. carbide ball tip.
- 0071684835** 1 Measuring insert with small cylindrical measuring face in hardened steel, 12 mm diameter, 2 mm long.
- 0071684820** 1 Measuring insert with cylindrical measuring face in hardened steel, 12 mm diameter, 2 mm long.
- 0071684827** 1 Measuring Insert with disc-shaped face in hardened steel for blind bores or short centring shoulders, 12 mm in diameter, 3 mm wide.
- 0071684822** 1 Measuring insert with cone-shaped measuring face in hardened steel, for diameters from 0,5 up to 5,5 mm.
- 0071684819** 1 Measuring insert with cone-shaped measuring face in hardened steel, for diameters from 5 up to 20 mm.
- 0071684828** 1 Attachment for interchangeable inserts with M1,4 thread. Supplied with 2 inserts No. 01860202 having a 2 mm dia. carbide ball tip
- 0071684852** 1 Attachment for interchangeable inserts with a M1,4, M2,5, or M3 thread. Supplied with connector M3 to M1,4 or M3 to M2,5. Can be aligned radially.
- 0071684818** 1 Measuring insert with a 1 mm dia. steel pin, hardened. Adjustable for depth measurement.

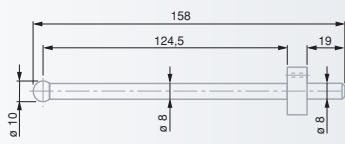

0071684817

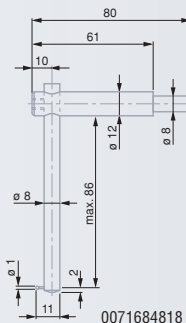

0071684818

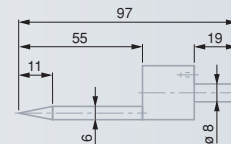

0071684822

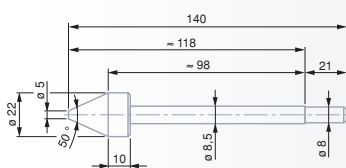

0071684819

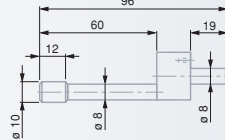

0071684820

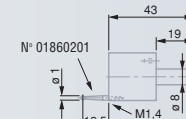

0071684826

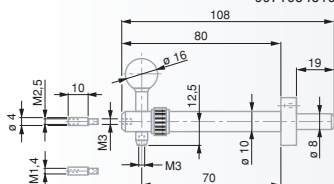

0071684852

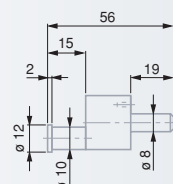

0071684835

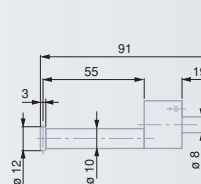

0071684827

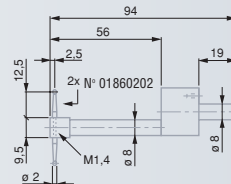

0071684828

## Accessories for measuring perpendicularity by means of a dial test indicator

(Used with TESA MICRO-HITE plus M, TESA MICRO-HITE and TESA-HITE 400/700)



**00760222** Insert holder for a dial test indicator (lever-type)

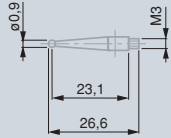
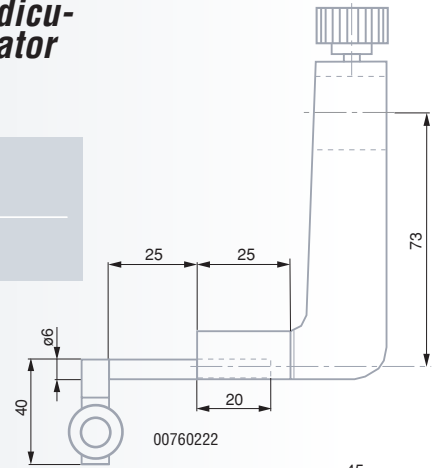

00760180

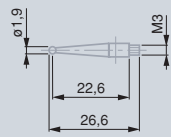

00760181

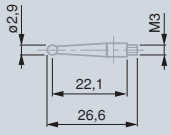

00760182

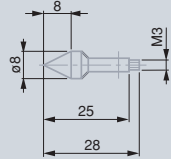

00760183

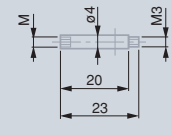

00760184/00760185

### Optional Accessories



<b>00760175</b>	Set of measuring inserts for T-H, T-H magna, M-H, M-H plus M	●	●
<b>00760186</b>	Set of measuring inserts for TESA-μHITE	●	●
<i>Provided in a suited plastic case including:</i>			
<b>00760177</b>	1 Insert holder	●	●
<b>00760187</b>	1 Insert holder	●	●
<b>00760178</b>	1 Hardened steel pin for grooves, centring shoulders, blind bores etc., angled through 8°	●	●
<b>00760179</b>	1 Tungsten carbide cylindrical pin for depth measurement	●	●
Measuring inserts, each with hardened steel ball tip			
<b>00760180</b>	1 item with a 0,9 mm diameter	●	●
<b>00760181</b>	1 item with a 1,9 mm diameter	●	●
<b>00760182</b>	1 item with a 2,9 mm diameter	●	●
<b>00760183</b>	1 Hardened steel measuring insert with a cone-shaped measuring face, 8 mm diameter	●	●
Extensions, 20 mm			
<b>00760184</b>	1 Extension with a M3 thread for M3	●	●
<b>00760185</b>	1 Extension with a M3 thread for M2,5	●	●

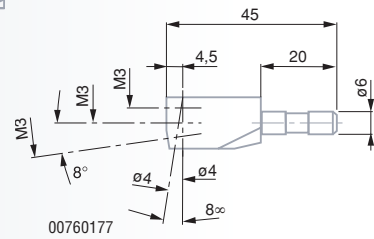

00760177

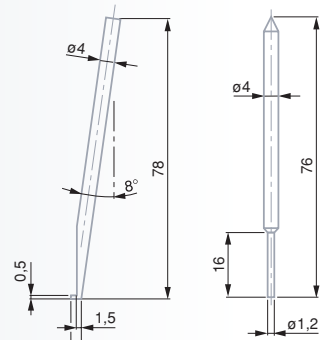

00760178

00760179

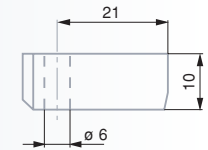
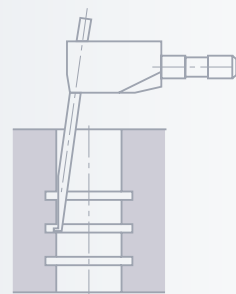
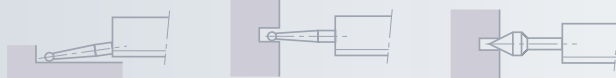

00760187

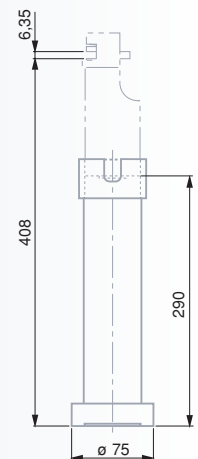
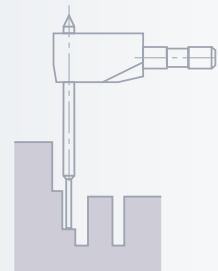

00760224



**0071684824** Master piece (zeroing) for establishing the probe constant

**00760224** Raising support for master piece  
Allows constant value to be captured as either insert holder for extending the application range is being used.

**00760124** Practice piece  
For one or two-dimensional measurements. Also for measuring straightness, perpendicularity and parallelism errors. Each User's manual POWER PANEL and POWER PANEL plus M includes some examples of programmed measurement cycles.

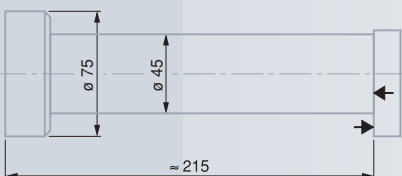

0071684824

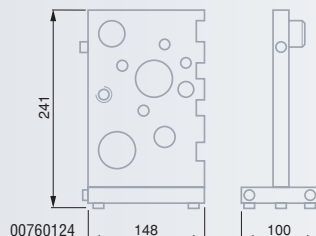

00760124

